



Farmers Electric Cooperative

A Touchstone Energy* Cooperative 

301 N. Hillcrest
Sulphur Springs, TX 75482

2000 I-30 E
Greenville, TX 75402

108 W. Marble
Wylie, TX 75098



Wednesday, July 3, 2019

Office of Hopkins County Judge
PO Box 288
Greenville TX 75403

Farmers Electric Cooperative Member: SHERRY HAMMOND
Service Order Number: 1906004957

Greetings:

Farmers Electric Cooperative, Inc. is requesting permission to construct electrical power distribution facilities which will cross County Road 1116 which is located, 535 ft west of CR 1117 in Hopkins County, Texas.

Site location map and construction sketches are enclosed. The construction sketch details the proposed work. All road crossings will have a minimum vertical clearance of 22 feet.

If you have any questions, please contact me at any time.

Sincerely,

Coy Hawkins

Project Coordinator
chawkins@farmerselectric.coop
Phone 903-513-5556

Submitted by Brandon Darrow
bdarrow@farmerselectric.coop
Field Engineering Coordinator

Enclosures

County Approval Section:

Approved:

Denied:

Authorized Signature: _____ Date: _____

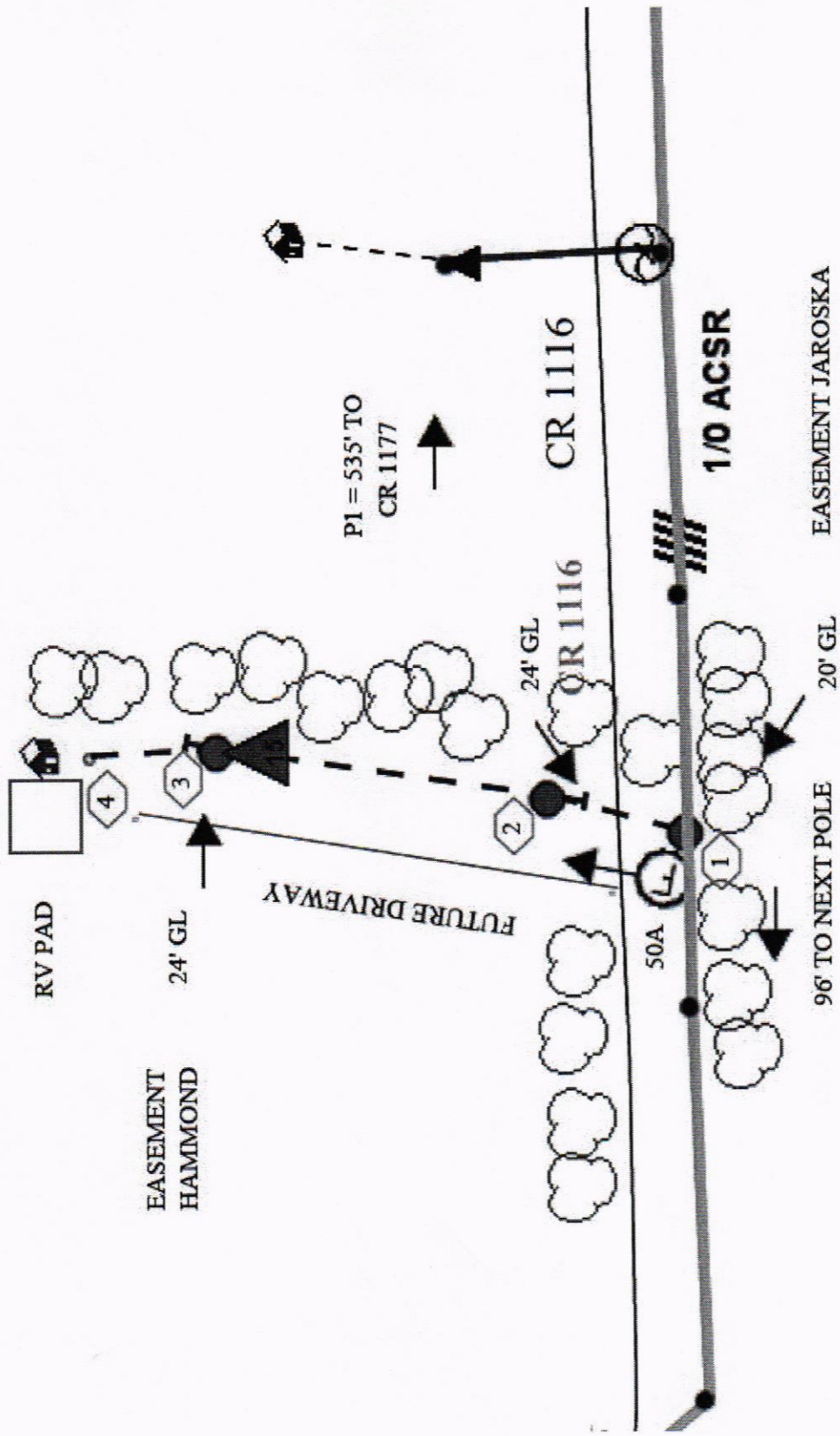

Sherry L Hammond
Service Order#
1906004957
Overhead crossing
on CR 1116.

